



ML WOOD

Fibre Refiner Mill ML-FRM



Mill for production of fines

- Exchangeable grinding tracks
- Adjustable grinding time
- Adjustable fineness of output material



ML WOOD

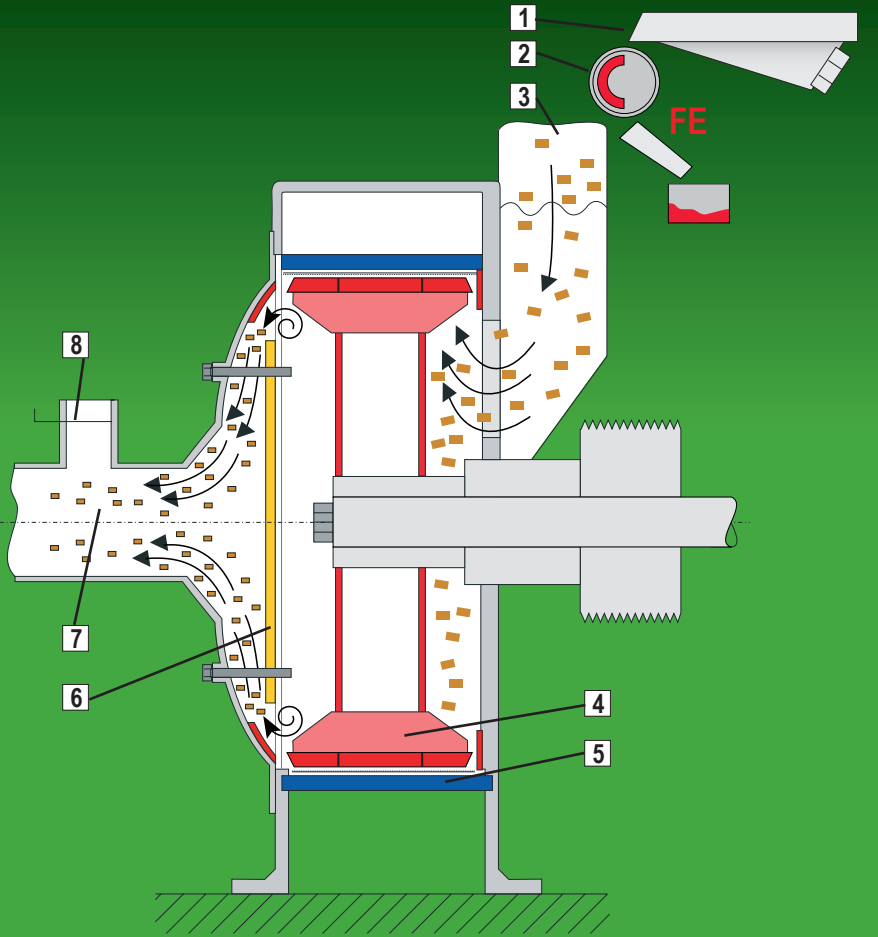

- 1** Vibration conveyor
- 2** Magnet drum
- 3** Infeed
- 4** Rotor
- 5** Grinding track
- 6** Distribution disc
- 7** Material extraction
- 8** By-pass

*Adjustable degree of fineness

The adjustment options are used to control the retention time of the material on the grinding track and the degree of fineness of the final product.

- Reduction of air quantity via by-pass (8)
- Axial adjustment of distribution disc (6) during operation
- Adjustment of rotor speed (4)
- Shape of grinding track (5)

Fibre Refiner Mill ML-FRM

Moisture up to 100%

- Material with a moisture content of up to 100% is milled into fibers.

No screens – no sparks

- Low risk of fire as the machine has no screens
- Material is milled exclusively by means of the grinding track.

No pit or stand

- The material is extracted through the door.

High availability

- Highly wear-resistant grinding tracks ensure long time life.

Short maintenance time

- Beater ledges can be changed without removal of the rotor.

Low maintenance costs

- Divided beater ledges – only the heavily used area is replaced.
- Replaceable wear protection inside housing



ML WOOD

A number of profiles for grinding tracks

Feeding material: Moisture content u up to 100 %

- Shavings and saw dust
- Knife ring flakes
- Flakes from residual wood
- Annual plants
- Chopped waste paper
- Flake material from inorganic substances
- Pellets and pre-crushed bricks



Sharp-edged, hardened grinding track for soft wood



Z-shape to improve the grinding efficiency



Sharp-edged, hardened grinding tracks for fibrous wood and other material

- **Production of fine and finest flakes**
- **Re-milling and super-fine milling of coarse material and industrial flakes for surface layer material, WFC, WPC**
- **Production of wood powder**
- **Fine milling of wood for animal bedding**
- **Coarse-grinding and milling of grain**
- **Use of annual plants for the production of blow-in-dust or thickening agent for substitute fuels**

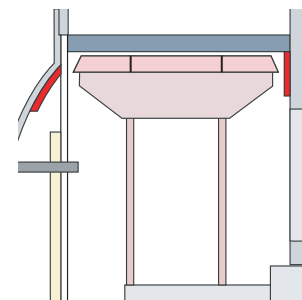

Wear-protection on casing and door
Exchangeable parts in red



ML WOOD

Fibre Refiner Mill*		9-43	12-43	14-55	16-55	18-70
Rotor diameter	mm	900	1200	1400	1600	1800
Number of grinding tracks	pcs.	9	15	20	22	30
Number of beater ledges	pcs.	18	24	30	36	40
Width of grinding track	mm	430	430	550	550	700
Drive power**	kW	90-132	110-160	250-315	250-400	315-500
Reduction performance	t/h bd	1,0-2,0	2,0-3,0	3,0-5,0	5,0-6,5	6,5-8,0
Weight	kg	2,4	3,3	5,5	6,5	8,0
Dimensions	l/b/h (m)	2,2/1,6/2,7	3,2/2,0/3,0	3,5/2,4/3,3	3,9/2,4/3,8	4,2/2,8/4,0

* Subject to technical modifications. Some of the machine equipment described here is available as an option.

** Depending on the type and moisture of the wood and the degree of fineness, the consumption power is 40 to 120 kW/t. The average value is 60 kW/t.

Note: The FRM is exhausted with 4 m³ air per kg material. The air resistance of the machine is approx. 2000 Pa.

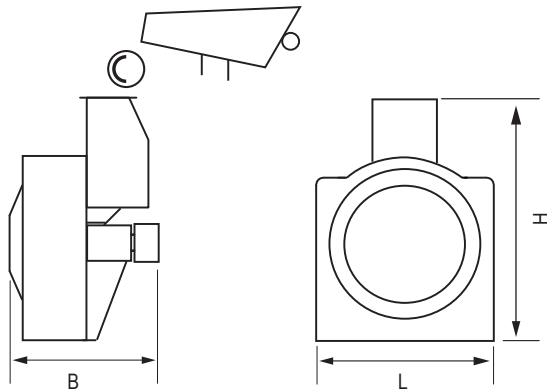

ML WOOD

B. Maier & R. Loth GmbH
 Wood Technology
 An der Bleiche 9
 33813 Oerlinghausen
 Germany

Phone: +49 (0) 5202 / 99689-10
 Fax: +49 (0) 5202 / 99689-90
 E-Mail: info@ml-wood.com
 Web: www.ml-wood.com